

THESE DRAWINGS AND SPECIFICATIONS ARE THE PROPERTY OF MDL INC. AND SHALL NOT BE REPRODUCED OR COPIED OR USED IN WHOLE OR IN PART AS THE BASIS FOR THE MANUFACTURE OR SALE OF ITEMS WITHOUT WRITTEN PERMISSION.

INTERPRET DRAWING IN ACCORDANCE WITH ANSI Y14.5M-1982

REVISIONS

LTR	DESCRIPTION	DATE	APPROVAL
-----	-------------	------	----------

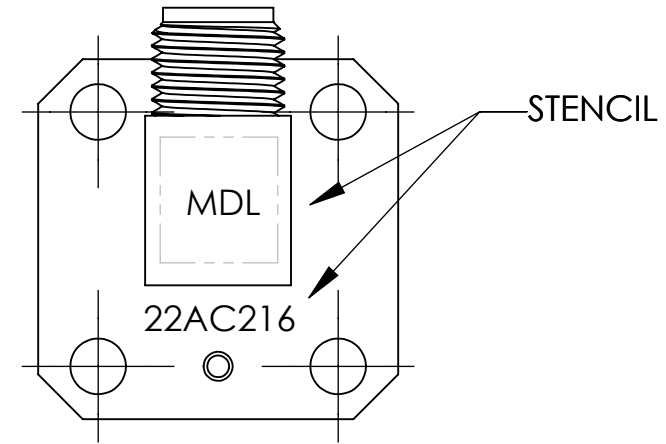
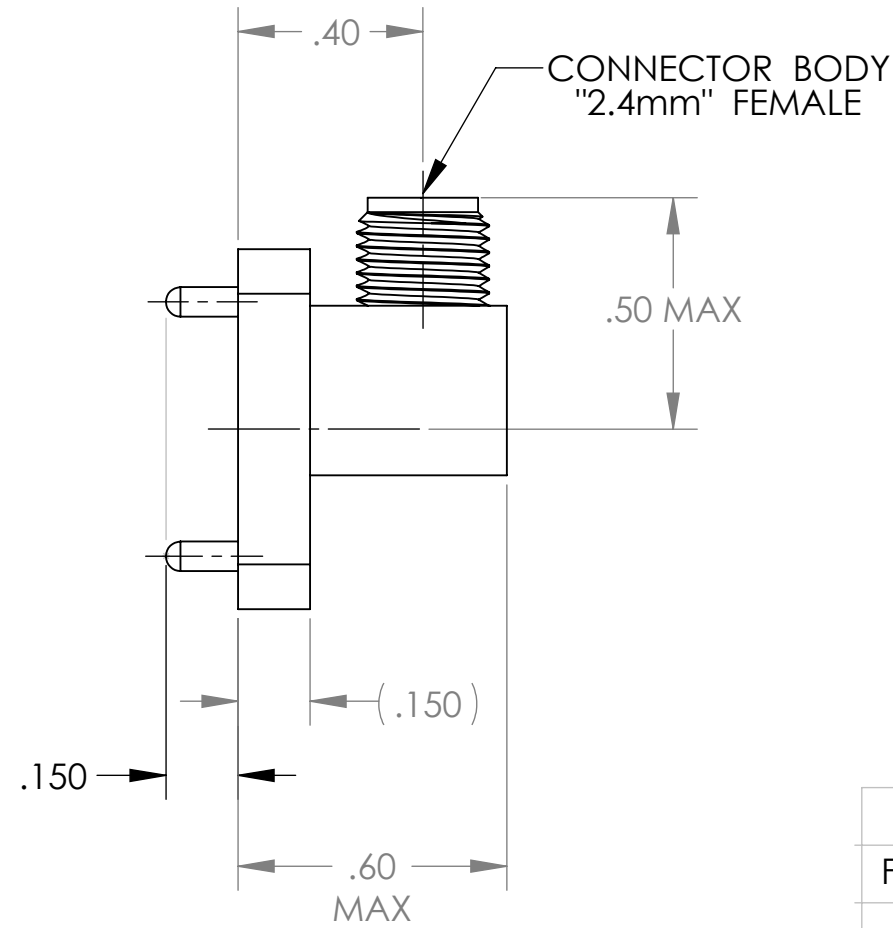
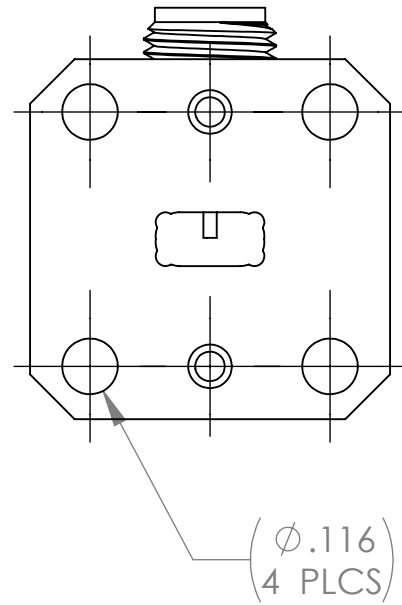

TECHNICAL SPECIFICATIONS	
FREQUENCY:	33.0 - 50.0 GHZ
VSWR:	1.35:1

MATERIAL AND FINISH		
CODE	MATERIAL	FINISH
C	ALUMINUM	CHROMATED

PART NO.	FLANGE CONFIGURATION	APPROX. UNIT WEIGHT
22AC216-1	WR-22 SQUARE COVER	7 Grams

REQ'D	REQ'D	REQ'D	REQ'D	ITEM OR SYM	DWG SIZE	PART NUMBER	DESCRIPTION	MATERIAL	MAT'L SPEC
-------	-------	-------	-------	-------------	----------	-------------	-------------	----------	------------

LIST OF MATERIAL

GROUP OR PART	NEXT ASSY	USED ON	NEXT ASSY	FINAL ASSY
	B-40-1229-1			
	APPLICATION		QUANTITY REQ'D	

UNLESS OTHERWISE SPECIFIED  
DIMENSIONS ARE IN INCHES  
TOLERANCES ARE  
.XX ± .02    .XXXX ± .0005  
.XXX ± .005    ANGULAR ± 30'  
FINISH 63 ✓

COMMERCIAL PUBLISHED TOLERANCES SHALL APPLY TO TUBING, BAR, PLATE, ETC. ALL THREADS TO BE CLASS 2A (EXTERNAL), OR 2B (INTERNAL). PLATED PARTS MUST FIT GAGES AND MEET SPECIFIED TOLERANCES AFTER PLATING.

DRAWN BY  
CHECKED BY  
ELECTRICAL ENGR.  
MECHANICAL ENGR.

DATE 8-8-17

**SIGNATURES ON FILE**

CAUTION:  
UNLESS THIS DRAWING BEARS THE SIGNATURE OF TWO AUTHORIZED ENGINEERING REPRESENTATIVES IN THE "APPROVED" BLOCKS IT IS PRELIMINARY AND UNDER NO CIRCUMSTANCES IS TO BE USED FOR MANUFACTURING PURPOSES.

DO NOT SCALE DRAWING

**MDL Inc**    MICROWAVE DEVELOPMENT LABORATORIES  
NEEDHAM, MASSACHUSETTS

W/G TO COAX ADAPTER  
OUTLINE DWG. WR-22  
22AC216

DWG SIZE	CODE IDENT. NO.	REV.
B	01456	10-45854

SCALE 2.5/1    WEIGHT    SHEET 1 OF 1

CAD FILE: