



## CX2503 2.2/5 Male Connector for .250 Corrugated Superflex

Rev 000

<b>Electrical</b>	
Impedance	50 Ohms
<b>Environmental</b>	
Operating Temperature	-40°C to +125°C
<b>Materials</b>	
Body	Tri-Metal Plated Brass
Contact	Brass
Contact Plating	Silver
Dielectric	PTFE
ROHS Compliant	



### Outline

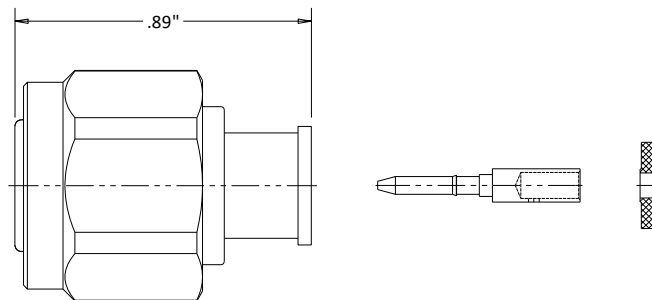

### STRIPPING DIMENSIONS

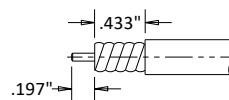

### Dimensional Tolerances

.X	±.030
.XX	±.010
.XXX	±.005